











Connection terminal, 400A, 4p, flat/round

Referencia **K240/4**
 Catalog No. **041628**

Delivery program

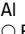
Product range			General switchboard accessories
Product function			Accessories panel building
Accessories			Terminations
Accessories			Terminals, 160 – 1000 A
Rated insulation voltage	U _i	V AC	1000
Description			Including labels for terminal marking U, V, W - X, Y, Z - L1, L2, L3 - T1, T2, T3 - PE, N, PEN,  Relationship of rated operational current → terminal capacity to IEC/EN 60439, VDE 0660 Part 500 or EN 50021 Outer terminal for round or sectoral conductor, other side for Cu strip
Rated operational current	I _e	A	400
Pole			4

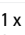
Terminal capacity

Cu/Al cable			Cu  Round stranded  Sectoral stranded  Round solid  Sectoral solid Al  Round solid  Sectoral solid
			1 x 50 - 240 2 x 25 - 120
Al cable			Al  Sectoral solid
			1 x 95 - 185 2 x 50 - 95
Copper band		mm	6 x 16 x 0.8 - 10 x 16 x 0.8
			# copper strip
conductor			25 x 15  Cu bar

Notes Conversion kits for strip terminal in cable connection available separately
 Terminal covers available separately

Technical data ETIM 5.0

Energy distribution systems (EG000015) / Regletas de conexión en barra (EC000275)			
Tecnología electrónica, de automatización y de mando de procesos / Material de aislamiento y de conexiones eléctricas / Energy distribution system / Rail terminal bar clamp (ec1@ss8-27-40-06-03 [ACO369007])			
Número de polos			4
Tipo de conexión			Tornillo
Número de conexiones < 6 mm ²			0
Número de conexiones 10 mm ²			0
Número de conexiones 16 mm ²			0
Número de conexiones 25 mm ²			0
Número de conexiones > 25 mm ²			8
Número total de conexiones			8
Método de montaje			Tornillo
Altura		mm	100

Anchura	mm	190
Profundidad	mm	115
A prueba de contactos		Si

Dimensions

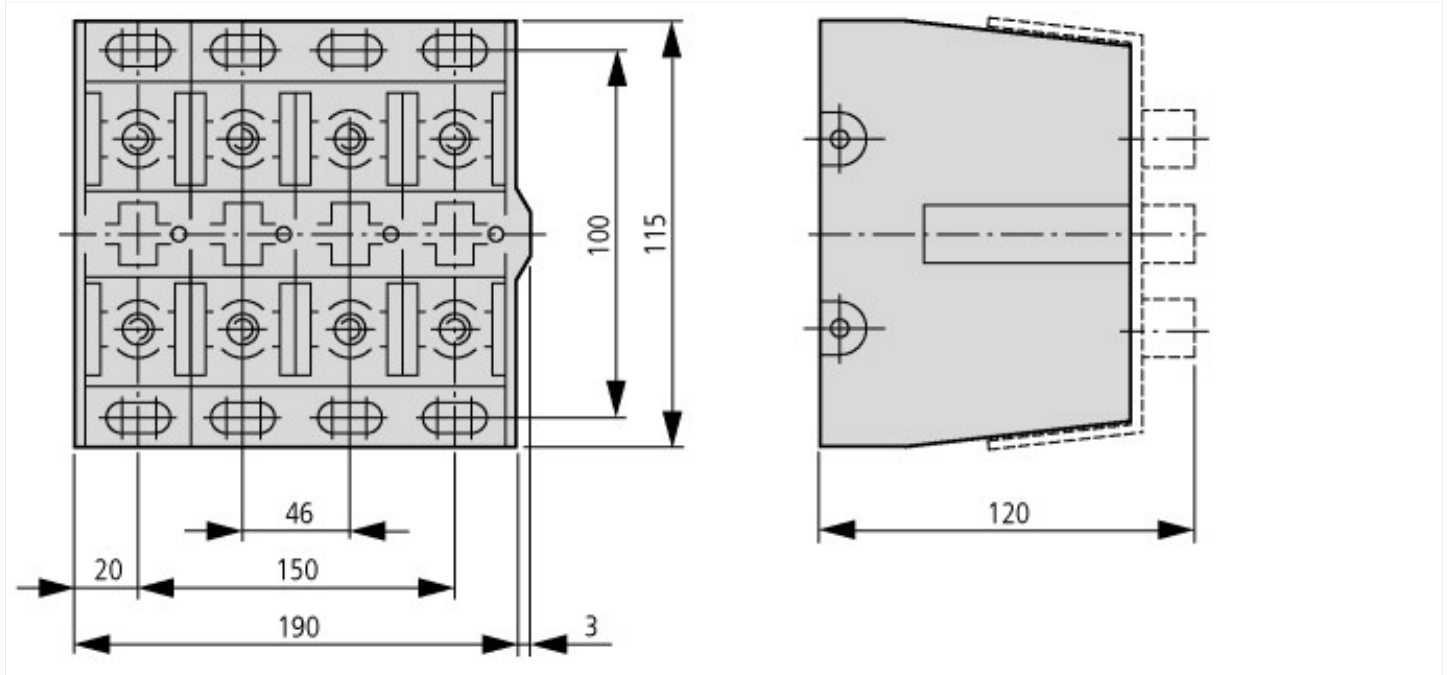

Additional product information (links)

AWA3400-0608 Connection terminal K240/...

AWA3400-0608 Connection terminal K240/... https://es-assets.eaton.com/DOCUMENTATION/AWA_INSTRUCTIONS/06081089.pdf